

Q2B[®] ELECTRO-MECHANICAL SIREN

It's not a fire truck unless it's got a Q-siren!



Federal's Q-siren produces easily recognizable long distance warning.

With over 50 years of fire service tradition and history, the Federal Q2B[®] is a beautifully streamlined, chrome-plated siren designed to provide unparalleled reliability for long-life operation. When mounted on emergency vehicles, the Q2B delivers powerful warning sound, more than any other electro-mechanical siren.

A heavy-duty coaster clutch is standard on Q2B models. The unique coaster clutch design allows the siren to deliver longer coast-down sound once power is removed, reducing battery drain. The "worry free" clutch is subject to very little wear and requires no service attention or adjustments. Use the standard electric brake for quick silencing of the siren.

Two Q2B models are available: **Q2B-012P** or **Q2B-012NN**. Both models are 12 VDC and include a grille, brake, and coaster clutch.

For increased convenience, the **Q2FSK** foot switch kit is also available. The kit comes with everything necessary to wire a footswitch to any Q2B model enabling the operator to power the siren "hands-free."

For flat and curved apparatus bumpers, a special bracket, the **Q-MT** is available. This rugged, durable mount is easy to install. Constructed of tough 3/8-inch steel, the Q-MT design protects the siren from the impact of rough roads.



The Q-MT mount is designed for flat or curved bumpers on fire apparatus.

QUICK REFERENCE

FEATURES

- 123 decibels at 10 feet.
- Chrome plating and highly polished stainless steel.
- "Worry Free" coaster clutch.
- Quality and reliability.

APPLICATION

- Long distance warning for fire apparatus

REPLACEMENT PARTS

Brake cover, ass'y	8209B009B
Front grille, ass'y	8280104A
Motor, 12V	8280080B
Solenoid	8280A007-01

RELATED PRODUCTS

e-Q2B [™] Electronic Siren	Bulletin #5107
PA300 Electronic Siren	Bulletin #5102
SmartSiren [®] Light/Siren Control	Bulletin #5113
Touchmaster [™] Delta Siren	Bulletin #5124

WARNING

This product produces LOUD sounds for requesting the right of way. Refer to the operating manual for guidelines on how to prevent possible hearing damage.

REGISTERED TRADEMARK

The distinctive sound of the Q2B electro-mechanical siren is a registered trademark owned by Federal Signal Corporation.

MOUNTING DIAGRAM FOR PEDESTAL MOUNT

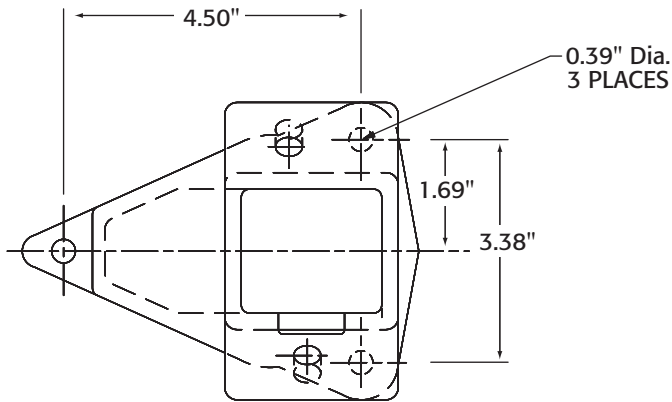

BUMPER CUTOUT FOR Q-SIREN (Q-MT)

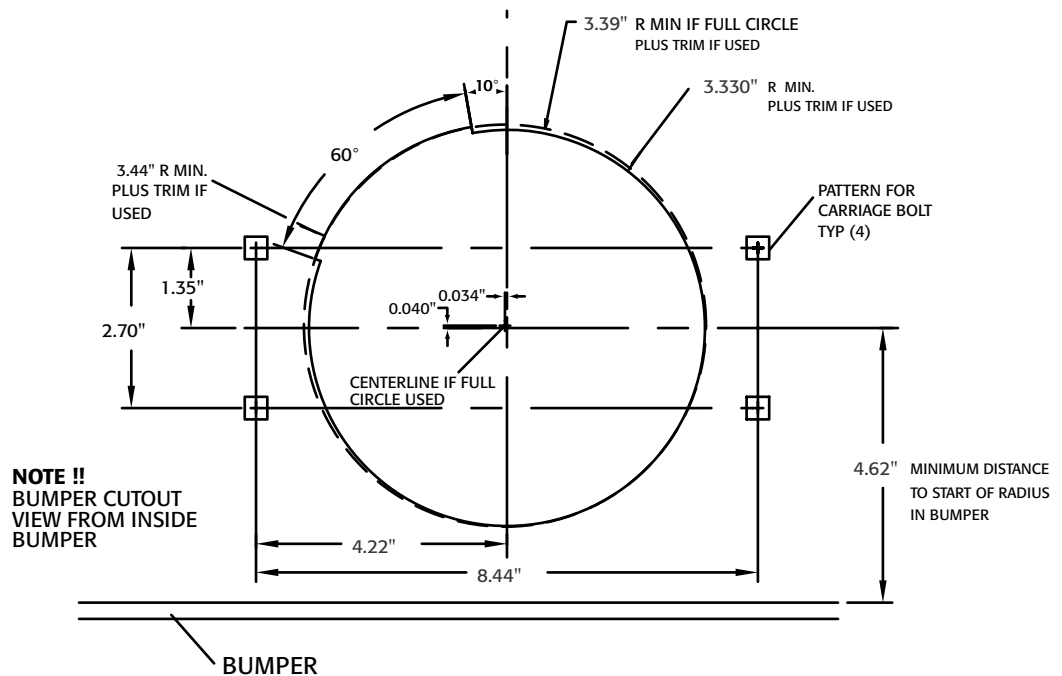

How To ORDER

- Specify model.
 - Q2B-P** Q-siren with pedestal mount and housing
 - Q2B-NN** Q-siren without pedestal mount or housing (designed for recess mounting)
- Specify accessories (if necessary).
 - Q-MT** Recess mount bracket for Q-siren
 - Q2FSK** Foot switch kit for Q-siren

FACTORY SET SPECIFICATIONS

Model	Volts	Operating Current	Sound Output
Q2B	12	100 amps	123dB @ 10 feet

DIMENSIONS

Model	Height in. cm.	Length in. cm.	Diameter in. cm.	Ship. Weight lbs. kg.
Q2B	10.5 26.7	14.0 35.6	10.0 25.4	49.0 23.0